

TECHNICAL DETAILS:

- MATERIAL: GRAY CAST IRON
- VIEWS SET TO FIRST ANGLE PROJECTION
- DIAMETER OF ALL HOLES IS 10 MM UNLESS OTHERWISE SPECIFIED
- DRAWING MADE ON A2 SIZE PAPER
- TITLE BLOCK DESIGNED AS PER ISO 7200:2004(E)
- ALL DIMENSIONS ARE IN MM
- MATERIAL DENSITY: 6.9 Mg/m³
- SCALE OF DRAWING SET TO 1:1

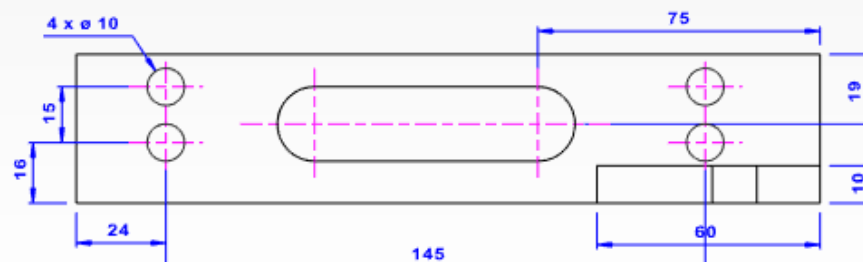

Responsible dept. R & D	Technical reference Shannon Bradley	Created by Mark Tyler	Approved by Frank Matthews	
MERIDIAN CASTINGS CO.		Document type Part Isometric Drawing	Document Status Released	1 : 1
		Title, Supplementary title Metal Mold Complete with inserts	MM955 345-1	
Rev. A	Date of issue 2021-09-20	Lang. en	Sheet 1/1	